

SITE AT R.S. DAG NOS. 3325(P), 3329 AND 3334 CORRESPONDING TO L.R. DAG NOS. 3397(P), 3401 AND 3406 IN MOUZA JAGADDAL, J.L. NO. 71, P.S.- SONARPUR, , DISTRICT- 24 PARGANAS (S), HOLDING NO.- 408, DWARIR ROAD, RAJPUR SONARPUR MUNICIPALITY, WARD NO. 25, , PINCODE – 700151.

AREA OF LAND (DEED) = 4235.45 SQ.M
 AREA OF LAND(PHY.) = 4237.45 SQ.M.
 39 MM WIDE EXCESS LAND RELEASED TO ROAD =2.014 SQ.M.
 1461 MM WIDE STRIP OF LAND RELEASED TO SONARPUR MUNICIPALTY=79.085 SQ.M.
 LAND AREA AFTER RELEASE =4156.35 SQ.M.
 LAND MARKED WITH RED BORDER

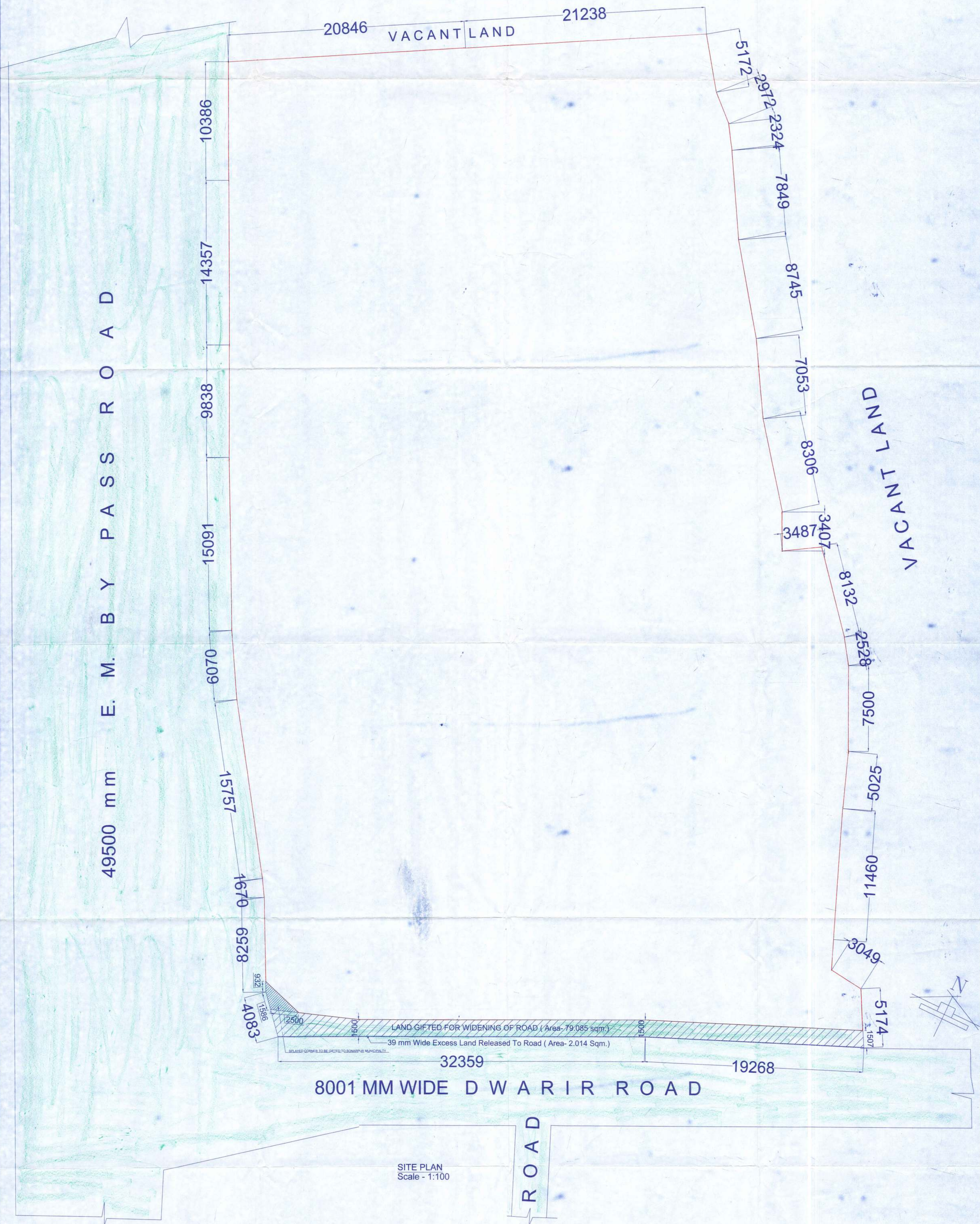

DECLARATION OF OWNER :
 THE RED MARKED PORTION OF LAND IS IN MY POSSESSION AND IS FREE FROM ALL ENCUMBRANCES.

For AARBURG ESTATES LLP
 Partner / Authorized Signatory

SIGNATURE OF OWNER

DECLARATION OF E.B.A :
 THE SITE IS MEASURED BY ME AND IT TALLIES WITH THE DEED PLAN AND ACTUAL MEASUREMENTS ARE MENTIONED IN THE SITE PLAN.

HARSH SANON
 COUNCIL OF ARCHITECTURE
 REGISTRATION NO. CA/90/13556

SIGNATURE OF E.B.A

APPROVED
 Plan No. 308/25/146 Dated: 18-8-22

Asst. Engineer
 RAJPUR-SONARPUR MUNICIPALITY